

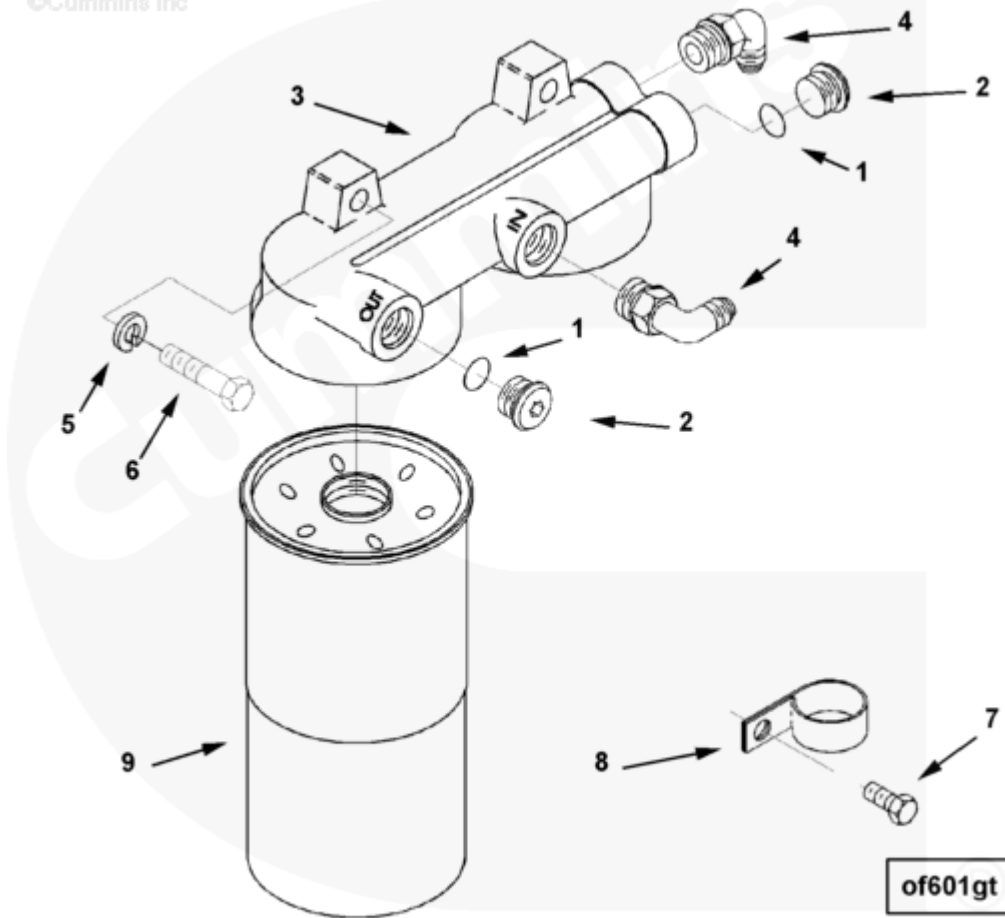

## Parts Catalog - Option Detail

Electronic Parts Catalog - Option Detail				
Option	Group	Graphic	Film Card	Date
OF6005-07	07.03	of601gt	K38	01-JAN-03
<b>Engines</b>	GTA38, K38, KTA38GC CM558, QSK38 CM2150 K106, QSK38 CM2150 MCRS, QSK38 CM850 MCRS			

©Cummins Inc



[SMALL](#) | [MEDIUM](#) | [LARGE](#)

Cart	Ref No	Part Number	Part Description	Required	Remarks
<a href="#">View My Cart</a>					
		<a href="#">OF6005-07</a>	Bypass Oil Filter		<a href="#">Dual element by-pass lube oil...(More)</a>
					filter, with replaceable
					spin-on cartridges,
					Mounted on pan rail, right

					bank side of engine.
<input type="checkbox"/>	1	<a href="#">43696 A</a>	O-Ring Seal	2	
<input type="checkbox"/>	2	<a href="#">139473</a>	O-Ring Plug	2	7/8 - 14 UNF.
<input type="checkbox"/>	3	<a href="#">3033405</a>	Lubricating Oil Filter Head	1	
<input type="checkbox"/>	4	<a href="#">3177198</a>	Male Union Elbow	2	
<input type="checkbox"/>	5	<a href="#">S 610</a>	Lock Washer	2	7/16 in.
<input type="checkbox"/>	6	<a href="#">106069</a>	Hexagon Head Cap Screw	2	7/16 - 14 X 2 in.
<input type="checkbox"/>	7	<a href="#">3065723</a>	Captive Washer Cap Screw	1	3/8 - 16 X 1 3/4 in.
<input type="checkbox"/>	8	<a href="#">3627412</a>	Clip	1	
<input type="checkbox"/>	9	<a href="#">3889311</a>	Oil Bypass Filter Element	2	

© 2019 Cummins Inc., Box 3005, Columbus, IN 47202-3005 U.S.A.  
Terms of Use and Disclaimers | Recommended System Requirements  
Need Assistance? Please click on the Contact Us button in the top right corner of any page.